



SEELAND BRÄU
NIDAU – SEIT 1999

Instructions for tapping party kegs



1. Place the keg on a table & position the tap hole facing forward



2. Wet the red rubber ring & press it into the tap hole



3. Turn the brown handle backward

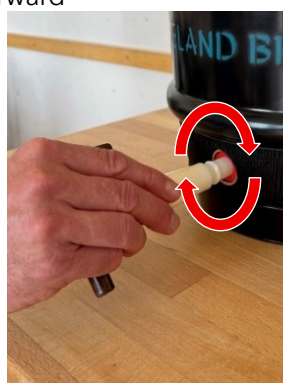

4. Press the tap **firmly** into place by turning it back and forth
> **NO hammer needed!**



5. Turn the brown handle forward & pour about half a glass of beer



6. Insert the black bleeder screw at the top & screw it in as far as it will go



7. Fill the glass (holding it at a slight angle)



8. Enjoy a fresh SEELAND BRÄU!
(the beer in the keg stays for about 6 hours)



9. Pull out the tap for transport & return the keg **as soon as possible**